

# PASSAGE OF LEWIS & CLARK

ABOARD THE LUXURIOUS *AMERICAN EMPRESS*

AUGUST 2-10, 2014

**\$100 ONBOARD  
EARLY BOOKING CREDIT**  
PER STATEROOM

IF BOOKED BY  
**MAR. 19,  
2014**

**FREE 1-NIGHT  
PRE-CRUISE  
PROGRAM**

CLARKSTON • SACAJAWEA STATE PARK • THE DALLES  
STEVENSON • ASTORIA • PORTLAND

FROM **\$3,795** PER PERSON

SPONSORED BY:

THE UNIVERSITY OF  
**ALABAMA**

A L U M N I



**GO** next

 **AMERICAN QUEEN™**  
STEAMBOAT COMPANY

# RIVER CRUISING

ALONG THE COLUMBIA & SNAKE RIVERS

THE ORIGINAL AMERICAN VACATION

**\$100 ONBOARD  
EARLY BOOKING CREDIT**  
PER STATEROOM

IF BOOKED BY  
**MAR. 19,  
2014**

**FREE 1-NIGHT  
PRE-CRUISE  
PROGRAM**



THE UNIVERSITY OF  
**ALABAMA**

A L U M N I

P.O. Box 861928  
Tuscaloosa, AL 35486-0017

PRSRRT STD  
U.S. POSTAGE  
PAID  
PERMIT #32322  
TWIN CITIES, MN

## DEAR ALABAMA TRAVELERS,

Discover a region of unparalleled natural bounty and spellbinding beauty, where majestic waterfalls plunge down mossy cliffs and powerful rivers flow through deep, awe-inspiring gorges, rugged high desert and mountains swathed in dense, emerald forests. Cruise from Clarkston to Portland and experience the pristine glory of the Pacific Northwest as you follow Lewis and Clark's epic passage along the Snake and Columbia Rivers, aboard the *American Empress*. The largest and most elegant riverboat west of the Mississippi, the *American Empress* is a modern vessel exuding the charm and lavish features of a 19th-century riverboat.

Your adventure begins with a stay in Spokane, Washington's second largest city, graced with beautiful parks, world-class museums, and a historic downtown featuring one of the largest urban waterfalls in the country. Then board the grand *American Empress* and watch breathtaking, ever-changing scenery glide by as you cruise to quaint riverside towns and memorable historic sites. Explore Sacajawea State Park, the site of Lewis and Clark's 1805 campsite, followed by The Dalles—the end of the Oregon Trail—where lovely scenery and small-town attractions await. In Stevenson, Washington, human ingenuity and Mother Nature's incredible power are on display at the Bonneville Dam and Columbia Gorge Interpretive Center Museum. Visit the oldest city west of the Rockies, Astoria, where splendid Victorian homes and maritime relics mingle with trendy cafes and shops, before your voyage concludes in Portland, the "City of Roses."

Experience spectacular northwest landscapes, storied towns, and the excitement of river boating along with fellow alumni as you discover the timeless allure of the river aboard the graceful *American Empress*. Your cruise includes fresh regional cuisine, elegant accommodations and fascinating shore excursions.

Reserve your spot on this remarkable riverboat voyage by March 19, 2014, to receive the one-night pre-cruise hotel stay in Spokane and the \$100 onboard credit per stateroom.

Sincerely,



Ashley Clayton  
Alumni Tour Coordinator

**AVAILABLE TO ALUMNI,  
THEIR FAMILIES AND FRIENDS.**

**SPACE ON THIS CRUISE IS LIMITED  
BOOK NOW!**

**CALL OR FAX**

**ASHLEY CLAYTON AT THE ALABAMA ALUMNI ASSOCIATION:**

**205-348-1547 • FAX: 205-348-5958**

**OR GO NEXT: 800-842-9023 • FAX: 952-918-8975**



# TRAVEL INSURANCE

We strongly suggest purchasing travel insurance. Travel insurance information will be sent to you by The University of Alabama Alumni Association with your confirmation letter.

## OPERATOR/PARTICIPANT AGREEMENT

**Go Next, Inc.** (hereinafter GN), located at 8000 West 78th Street, Suite 345, Minneapolis, Minnesota 55439-2538, in return for full payment by you of the amount specified, is responsible to arrange for the transportation, accommodations and other services specified as included in this brochure as and to the extent you have selected them, and subject to the following terms and conditions. Unless expressly specified as included by this brochure, services, taxes and fees are not included.

**RESPONSIBILITY:** GN is responsible to you for arranging all included transportation, accommodations and other services. However, in the absence of negligence on its part, GN and the sponsoring association are not responsible for personal injury, property damage, or any other loss, claim or damage arising out of or related to goods or services offered or included. GN and the sponsoring association are not responsible for personal injury, property damage or any other loss, claim or damage related to or arising out of, in whole or in part, the acts or omissions of any direct air carrier, cruise line, hotel, ground operator, or other person not its direct employee or not under its exclusive control supplying any services or providing any goods offered or included. GN and the sponsoring association are not responsible for personal injury, property damage or any other loss, claim or damage arising out of, either in whole or in part, acts of God, weather, labor strife, government actions, mechanical breakdowns, war-like acts, terroristic activities or other causes reasonably beyond the respective control of GN and the sponsoring association. GN and the sponsoring association are not responsible for incidental or consequential losses or damages.

Neither GN nor the American Queen Steamboat Company (hereinafter AQSC) nor the sponsoring association are responsible for any penalty, loss or inconvenience resulting from air or land arrangements made independently by travelers, including non-refundable conditions, restricted travel or frequent flyer tickets.

**PAYMENT:** A deposit in the amount shown on the reservation form and a signed agreement for each person is required to secure reservations. Final payment is due as shown on the reservation form. If the cruise or flight is fully booked, your payment will be returned or, with your authorization, your name placed on a waiting list. ALL CHECKS AND MONEY ORDERS ARE TO BE MADE PAYABLE AS INDICATED ON THE RESERVATION FORM. CONFIRMATION IS SUBJECT TO RECEIPT BY GN OF DEPOSIT AND A SIGNED AGREEMENT.

**PRICES:** GN RESERVES THE RIGHT TO INCREASE PRICES IN THE EVENT OF ANY INCREASED SECURITY OR FUEL RELATED SURCHARGES, OR FARE INCREASES IMPOSED BY THE AIRLINE OR CRUISE LINE THAT MAY BE IN PLACE AT THE TIME OF TICKETING OR TRAVEL, FOREIGN OR DOMESTIC TAX INCREASES, OR ADVERSE CURRENCY EXCHANGE FLUCTUATIONS, AFTER MARCH 01, 2013. GN RESERVES THE RIGHT, IF NECESSARY OR ADVISABLE, TO SUBSTITUTE HOTELS BUT IS NOT OBLIGED TO DO SO.

The price is based on tariffs in effect for estimated 2014 prices as of March 01, 2013. Prices increase every year, and it is therefore possible that increases could occur after the printing of this brochure and in advance of your departure.

**BAGGAGE:** GN CANNOT BE HELD RESPONSIBLE FOR LUGGAGE LOST OR DAMAGED. YOU SHOULD GIVE IMMEDIATE NOTICE OF ANY LOST OR DAMAGED LUGGAGE TO THE INVOLVED AIR CARRIER, HOTEL, CRUISE LINE AND TO YOUR OWN INSURANCE COMPANY.

**AIRCRAFT AND CRUISE LINE BOARDING:** GN CANNOT BE HELD RESPONSIBLE FOR AIRLINE OR CRUISE LINE DELAYS.

Aircraft and cruise line boarding privileges are limited to persons whose full payment and signed agreement have been received by GN and whose names are on the manifest given to the carrier before departure. Improper documentation, inadequate proof of identity, inadequate proof of age for children under 2, or any other reason may result in denial of boarding privileges. The air carrier and cruise line reserve the right to decline, accept or retain any person on the flight or cruise at any time within their sole discretion. If you are denied boarding privileges, you forfeit all monies paid and will be assessed any non-recoverable costs.

**ADVANCE TRAVEL INFORMATION:** U.S. citizens or permanent residents of the U.S. traveling exclusively inside U.S. borders do not need a passport or visa for travel. Homeland Security laws require that all guests travel with government-issued photo identification (ID) (such as a driver's license) at all times. ID must be presented at the time of boarding. Guests without proper ID will be denied boarding. AQSC is required to provide all guests' ID information including ID number, expiration date, and place of issue to the Coast Guard and/or other government entities prior to the vessel's departure. Guests must provide this information to AQSC in advance. Travel documents will not be released until received. Canadian

citizens or permanent residents of Canada entering the U.S. are required to bring their passport. For other nationalities, passports are required to enter the U.S. It is your responsibility to check with your local U.S. embassy/consulate to confirm visa requirements and to obtain the proper visa/U.S. alien card (green card).

**AQSC'S LAND PACKAGES/SHORE EXCURSIONS:** Tours are operated in the various ports of call by AQSC or local tourist service companies contracted by the cruise line. They are not under the control of GN. Cancellation penalties may differ from the cruise program related penalties. AQSC may modify the cruise itinerary up to and during the voyage.

**NOTICES:** Any complaints or claims against GN must be made in writing and received by GN within 90 days after scheduled termination of the trip. Any action or suit against GN must be commenced within 1 (one) year after scheduled termination of the trip or be forever barred.

The rights and remedies relating to cancellations and major changes prior to departure, made available under this agreement are in addition to any other rights or remedies available under applicable law. However, we offer any refunds under this agreement with the express understanding that the receipt of that refund by you waives all other remedies.

While Go Next makes every effort to adhere to the specifics shown in this brochure, all information contained herein is subject to change. Go Next is not responsible or liable for typographical errors, omissions or misprints.

**INSURANCE:** Travel insurance is available and can provide coverage for unforeseen circumstances that could disrupt your trip. See panel above for details.

**IF YOU CHANGE PLANS OR CANCEL, YOUR RIGHTS TO A REFUND ARE LIMITED:** The following charges will be assessed for cancellations.

If you cancel or change plans more than 100 days prior to departure, a full refund, less a \$200 per person administrative fee plus any applicable pre- and/or post-cruise program cancellation fees, is provided. Any refunds are provided only in accordance with the following schedule. Any requests for cancellation must be communicated to GN in writing. Applicable refunds, if any, will be made within 14 days after the cancellation.

**CANCELLATIONS:** Upon receipt of written cancellation from you, the following fees will apply:

Cruise Program cancellations received 101 days or more prior to departure, \$200 per person; 100-61 days prior to departure, 50% of total fare; 60-31 days prior to departure, 75% of total fare; 30-0 days prior to departure, 100% of total fare.

**HEALTH:** Any physical or mental condition requiring special medical attention or equipment must be disclosed in writing to GN at the time the participant makes a reservation. GN may reject the reservation of any person who, in the opinion of GN is unfit for travel or might be a danger to themselves or incompatible with others on the trip. Participants requiring special assistance, including without limitation those who permanently or periodically use a wheelchair, must be accompanied by someone who agrees to provide the required assistance. GN reserves the right to terminate the participation of any participant whose conduct or condition materially inconveniences other participants.

THERE ARE NO EXCEPTIONS OF ANY KIND (INCLUDING MEDICAL EXCEPTIONS) TO THESE POLICIES. No refunds will be made for any portion of the arrangements we have made for you that are not actually utilized by you. There is no variance from these policies for the services we arrange as described in this brochure.

California Seller of Travel Registration No. 2077280-40, Washington Seller of Travel Registration No. 602-900-725, Iowa Seller of Travel Registration No. 477

### DISCLAIMER

The University of Alabama Alumni Association is making the opportunity to participate in this Go Next, Inc. arranged trip. The University of Alabama Alumni Association has no connection or responsibility with regard to the transportation or other facilities offered by the travel agency making arrangements for the trip and it is not a contracting party with regard to any of the arrangements made or to be made. I understand that I must contract directly with the travel agency arranging the trip and that contractual responsibilities, if any, are directly between the travel agency and me. I am fully cognizant of all risks of travels and arrangements for trips of this nature and fully disclaim, waive, and discharge The University of Alabama Alumni Association from any and all liability, claims or responsibilities with regard to the proposed trip and arrangements made with respect thereto, even if caused by the negligence or purported negligence of The University of Alabama Alumni Association.

# RESERVE YOUR PASSAGE OF LEWIS & CLARK CRUISE TODAY!

## SEND TO:

Attn: Ashley Clayton  
Alabama Alumni Association  
P.O. Box 861928  
Tuscaloosa, AL 35486-0017  
aclayton@alumni.ua.edu  
**205-348-1547 or**  
**Call Go Next at 800-842-9023**

## THE UNIVERSITY OF ALABAMA ALUMNI ASSOCIATION (265)

AUGUST 2-10, 2014

CLASS YEAR

**I/WE PREFER GO NEXT CORRESPONDENCE VIA:**  Email  Mail  Both

**PLEASE MAKE MY/OUR RESERVATION FOR CRUISE PROGRAM WITH FREE 1-NIGHT PRE-CRUISE HOTEL STAY. (PLEASE NOTE: Airfare and airport transfers are not included.)**

I/We will make my/our own transportation arrangements.

Please contact me/us to discuss independent air options.

Stateroom/Suite category requested: 1st choice \_\_\_\_\_ 2nd choice \_\_\_\_\_

Bed request:  Twin (2 beds)  Queen

Single and Triple accommodations are an additional cost and subject to availability.

Request:  Single  Triple

### All guests must travel with a government-issued photo ID.

GUEST 1: Full Name (as it appears on your government-issued photo ID)

First Middle Last Title

Preferred name on name badge  M Birth Date     
 F (MM/DD/YYYY)

GUEST 2: Full Name (as it appears on your government-issued photo ID)

First Middle Last Title

Preferred name on name badge  M Birth Date     
 F (MM/DD/YYYY)

Email Address

Mailing Address

City  State  ZIP

Home Phone  Cell Phone

Roommate (if different from above)

Adjacency Request

**SIGNATURES REQUIRED BY EACH PERSON TRAVELING** INCLUDING PARENT/GUARDIAN FOR MINOR CHILDREN: I/We have read, received a copy of, understand, and accept the terms and conditions stated in the Operator/Participant Agreement.

**SIGNHERE X** \_\_\_\_\_

**SIGNHERE X** \_\_\_\_\_

**DEPOSIT AND FINAL PAYMENT: A deposit of \$600 per person is due with your reservation application.** Make checks payable to Go Next. Full payment is required by April 24, 2014. Reservations received after this date must be accompanied with full payment.

Please reserve \_\_\_\_\_ space(s). Enclosed is my/our deposit for \$ \_\_\_\_\_. Deposits may also be made by credit card; however, **all FINAL payments are required to be made by check or cash.**

I/We authorize Go Next, Inc. to charge my/our deposit for \$ \_\_\_\_\_ to:  Visa  MasterCard

Name (as it appears on your credit card) \_\_\_\_\_

**SIGN HERE X** \_\_\_\_\_  Billing address same as above

Billing Address (if different from above) \_\_\_\_\_

Card Number \_\_\_\_\_ Security Code \_\_\_\_\_ Exp. Date \_\_\_\_\_

Making a deposit or acceptance or use of any vouchers, tickets, goods, or services shall be deemed consent to and acceptance of the terms and conditions stated in the applicable Operator/Participant Agreement, including limitations on responsibility and liability.



# A JOURNEY LIKE NO OTHER

## INCLUSIONS

Welcome to the magnificent Pacific Northwest, where the Columbia and Snake Rivers wind through gentle hills, imposing mountains, dramatic canyons and fertile fields. The land appears today much like it did to Lewis and Clark in 1805—majestic, unspoiled and unimaginably glorious. From the awe-inspiring beauty of the Columbia River Gorge and the cascading majesty of Multnomah Falls to the masterfully crafted wines of Washington's celebrated wine country, treat yourself to the region's unforgettable natural wonders and attractions.

The incredible scenery and intriguing history of the Great American West come to life on board the *American Empress*, your floating boutique hotel. Enjoy casual elegance and sweeping river views aboard the largest and most elegant riverboat in the Pacific Northwest, combining Victorian-inspired décor with frontier flair. Unwind in the Paddlewheel Lounge and sample regional cuisine in the beautifully appointed dining room. And at the end of the day, retreat to the comfort of your fine accommodations.

Discover one of America's most treasured, bountiful regions on a journey aboard the 223-passenger *American Empress*, specifically designed to celebrate the centuries-old tradition of exploration in the west. Experience the rich beauty, history and adventure unique to the river boating tradition from the remarkable perspective of the river.

- 7-night voyage, including all meals, aboard the *American Empress*
- 1-night pre-cruise hotel stay in Spokane, Washington
- Complimentary hop-on, hop-off shore excursions with a dedicated fleet of luxury coaches
- Regional Pacific Northwest Cuisine utilizing fresh ingredients creatively combined with contemporary flair
- Complimentary wine and beer with dinner
- Complimentary cappuccino, espresso, specialty coffees, bottled water and soft drinks throughout your voyage
- Gracious service from a friendly all-American staff
- Smart-casual attire throughout your voyage, no formal wear required
- Daily lectures by the Riverlorian, your onboard history and culture expert
- Showboat-style entertainment including cabaret shows, one-man historical acts and dancing to big band music

## GO NEXT EXCLUSIVE BENEFITS

- **1-Night Pre-Cruise Hotel Stay** at the DoubleTree by Hilton Hotel Spokane City Center or similar, breakfast, taxes, portage and transfers to the *American Empress*
- **Private Go Next reception** including hot and cold canapés, wine, beer and soft drinks
- **\$100 onboard early booking credit** per stateroom
- **Complimentary bottle of wine** per stateroom
- **Services of an onboard Go Next program manager**
- **Exceptional value**



Astoria, Oregon

## RIVER CRUISE

### AUG 2 SPOKANE, WASHINGTON

Your journey begins with a one-night stay at the DoubleTree by Hilton Hotel Spokane City Center, a contemporary four-star retreat located in the heart of Spokane, Washington, just steps from the INB Performing Arts center and the shops at River Park Square. Known as the “Capital of the Inland Empire,” Spokane is the vibrant cultural and economic hub of the Inland Northwest. Set along the Spokane River, the thriving downtown district draws visitors with its grand, historic buildings, trendy boutiques and top-notch restaurants.

### AUG 3 SPOKANE/CLARKSTON, WASHINGTON

Transfer to Clarkston and embark on your riverboat cruise aboard the elegant *American Empress*.

### AUG 4 CLARKSTON, WASHINGTON

Situated at the confluence of the Snake and Clearwater Rivers, in the beautiful Lewis-Clark Valley—the centuries-old home of the Nez Perce Indians—are the sister cities of Lewiston, Idaho and Clarkston, Washington. Founded in the 19th century as a way station for travelers bound for the Idaho goldfields, today Clarkston offers visitors resplendent scenery and a wealth of cultural attractions.

**INCLUDED EXCURSION** In the morning, stop at Nez Perce National Historical Park, which chronicles the indigenous tribe and its relationship with the Corps of Discovery expedition. Then discover Clarkston, Washington, and delve into colorful local culture at the Clarkston Community Historical Society and Museum, before exploring its downtown shopping district at your leisure.

### AUG 5 RIVER CRUISING

Relax and take in the picturesque landscapes as you leisurely cruise along the Snake River.

### AUG 6 SACAJAWEA STATE PARK, WASHINGTON

At the confluence of the Snake and Columbia Rivers, this 284-acre park occupies the former site of Ainsworth, a 19th-century railroad town. The land also holds unique history—in 1805, Lewis and Clark and their Shoshone Indian guide camped here during their fabled expedition. Sacajawea State Park features a blend of ponds, marshes, sand dunes, and over 9,000 feet of freshwater shoreline, as well as an interpretive center. Nearby, you’ll find Washington’s famed Walla Walla Valley, home to the region’s award-winning wineries.

**INCLUDED EXCURSION** Visit Sacajawea State Park and its interpretive center, featuring Lewis and Clark-themed exhibits and Native American implement displays; followed by the Country Mercantile Store, a working farm and shop offering agricultural demonstrations, gourmet foods and other unique local gifts.

**PREMIUM CHOICE TOURS** will also be offered in each port of call for an additional charge. Itinerary, hotel and shore excursions are subject to change.

## ASTOUNDING SCENERY

Experience the Pacific Northwest, where diverse landscapes intertwine to form an incredibly gorgeous painting, stirred to life by the cool, gentle breeze. Here nature reveals her unimaginable beauty and range—from surreal, emerald forests and sparkling waterfalls to near-desert bluffs and staggering, vertical canyon walls. Carved by dramatic landslides, volcanic upheavals, and raging floods thousands of years ago, these rugged lands provide some of the most astounding scenery in America. From the decks of the *American Empress*, discover this renowned region in perfect elegance and ease, as scenes of unspoiled natural glory unfold one by one.





## E ITINERARY

### AUG 7 THE DALLES, OREGON

This quintessential frontier town rests on a crescent bend of the Columbia River, between Mt. Hood and Mt. Adams, and welcomes visitors with its picturesque backdrop of forests, orchards and high desert. Once known as the end of the Oregon Trail, The Dalles occupied a strategic transfer point for west-bound pioneers heading to the Willamette Valley.

**INCLUDED EXCURSION** The hop-on, hop-off motor coach makes stops at the Original Courthouse Museum, known as the first courthouse west of the Rocky Mountains; The Dalles Visitor's Center; the Fort Dalles Museum and Interpretive Center, which showcases unique military and pioneer remnants, including Oregon Trail wagons; the downtown shopping district; and Sunshine Mill Winery, a state-of-the-art boutique winery housed in a 130-year-old abandoned wheat mill.

### AUG 8 STEVENSON, WASHINGTON

Nestled in the heart of the Columbia River Gorge National Scenic Area, the friendly, laid-back town of Stevenson packs in lovely scenery and layer upon layer of history. Peaceful riverfront parks and downtown delicatessens, pubs, antique stores and art galleries offer a dose of small-town charm while the nearby Columbia Gorge Interpretive Center Museum brings to life 15,000 years of geological glory and compelling regional history.

**INCLUDED EXCURSION** Traveling by motor coach, visit the Columbia Gorge Interpretive Center Museum and learn about the incredible geological forces that shaped this astounding region, and discover Native American legends, petroglyphs, and other captivating artifacts and exhibits. Visit the first dam built on the Columbia River, the Bonneville Dam, a National Historic Landmark and a monument to human ingenuity with its massive turbines and fascinating fish ladders.

### AUG 9 ASTORIA, OREGON

Where the Columbia River meets the Pacific Ocean, you'll find the oldest city west of the Rockies, Astoria—named for John Jacob Astor, the owner of the American Fur Company. This "Little San Francisco" is bursting with character, from its steep hillsides blanketed in sprawling Victorian homes and weathered Deco-era buildings to its maritime relics and downtown studded with chic cafes and whimsical shops.

**INCLUDED EXCURSION** Begin with a stop at the Riverwalk, a four-mile walkway overlooking the Columbia River, flanked by shops, cafes and historic canneries. Continue to some of the city's renowned historic attractions, including the 19th-century George Flavel House and Carriage House Museum, the marvelous Queen Anne-style residence of a prominent local millionaire; Clatsop County Heritage Museum, illustrating early pioneer life and logging and maritime industries; and the Astoria Column, awarding splendid panoramas from its dramatic perch 600 feet above sea level.

### AUG 10 PORTLAND, OREGON

Disembark in the morning and bid farewell to the *American Empress*. Transfers to Portland airport, for return flights home, are an additional cost and should be scheduled after 9AM.

**Note:** *If you are interested in an optional Premium Choice Tour of Portland, your return flight should be scheduled to depart from Portland after 3PM. Many of the late departures from Portland are overnight flights.*

## LIFE ON THE WATER

Life on the *American Empress* is as unique and enriching as the riverboat tradition itself. Night after night, music fills the majestic showroom, elegantly furnished with crystal chandeliers, glorious period-wallpaper, and comfortable seating, reminiscent of a lumber baron's estate home. By day, the Riverlorian, your onboard historian, offers lectures and tales of the frontier. The River Grille and Paddlewheel Lounge are meeting points for old and new friends. And the elaborate Romanov Dining Room, reflecting the Northwest's rich Russian influence is graced with gilded columns, rich marble, and jewel-toned upholstery—the perfect backdrop to sample inspired regional dishes.







Columbia River Gorge

# THE GREATEST VALUE

## PRICING

### SUITES WITH VERANDA

**A** \$5,795

**Vista View Deck** Elegantly furnished suite, cozy sitting area, French doors that open onto a veranda, two single beds convertible to queen, and bathroom with shower.

### SUPERIOR VERANDA STATEROOMS

**B** \$5,295

**Vista View, Discovery & Frontier Decks** French doors that open onto a private veranda\*, two single beds convertible to queen, and bathroom with shower. \*Stateroom 403 offers additional square footage in lieu of private veranda.

### DELUXE VERANDA STATEROOMS

**C** \$4,795

**Discovery & Frontier Decks** French doors that open onto a private veranda, two single beds convertible to queen, and bathroom with shower.

### OUTSIDE STATEROOMS WITH WINDOW

**D** \$4,395

**Explorer Deck** Large window, two single beds convertible to queen, and bathroom with shower.

### VERANDA STATEROOMS

**E** \$3,795

**Vista View Deck** French doors that open onto a veranda, two single beds convertible to queen, and bathroom with shower.

*Luxury Suites, Single and Triple Staterooms are available upon request.*

Fares are per person, double occupancy. Onboard meals, refreshments, & entertainment are included. Airfare and airport transfers are not included. Please contact Go Next for information regarding transportation options to Spokane and/or from Portland. Port charges of \$109 per person and gratuities are additional.

## OPULENT COMFORT

The elegant pearl of the Pacific Northwest, the *American Empress* is a breathtaking combination of modern comfort and Victorian charm. All suites and staterooms aboard the *American Empress* feature flat-screen TVs, extravagant bedding and fine linens, mini refrigerators, and luxury hotel-style service. Take in resplendent scenery as you enjoy a quiet respite in your stylish suite or deluxe stateroom, designed with all the comforts of home. Life aboard the *American Empress* flows like a gentle river—at your pace and according to your taste.





**VISTA VIEW DECK**

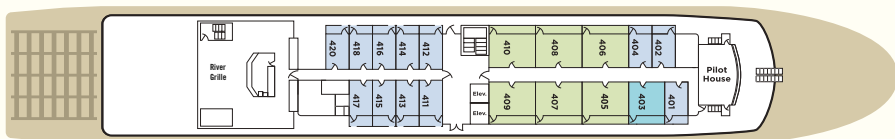

**DISCOVERY DECK**

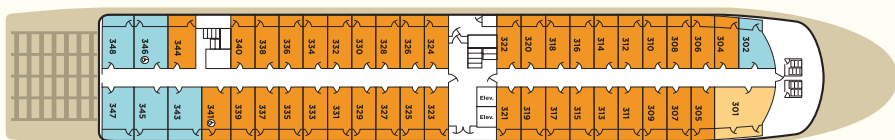

**FRONTIER DECK**

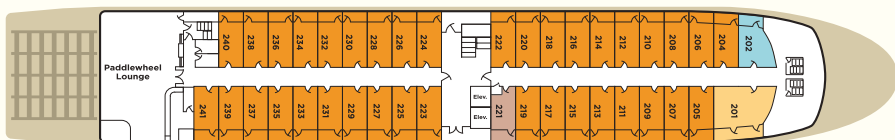

**EXPLORER DECK**

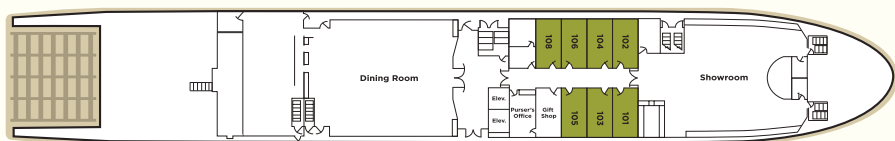

THIS MAP REPRESENTS APPROXIMATE LOCATIONS